

CAR MP3 PLAYER

User'Manual

Description of panel

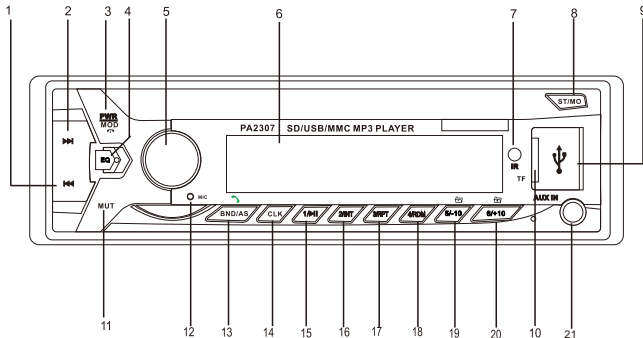

- | | | |
|----------------------|-----------------------|-----------------------------|
| 1. Previous | 8. Stereo/Mono switch | 15. Number 1 / Pause |
| 2. Next | 9. USB slot | 16. Number 2 / Browse |
| 3. Power/Mode switch | 10. TF Card slot | 17. Number 3 / Repeat |
| 4. EQ | 11. Mute | 18. Number 4 / Random |
| 5. Volume Knob | 12. MIC | 19. Number 5 / Previous 10- |
| 6. Display | 13. BND/AS | 20. Number 6 / Next 10+ |
| 7. Remote window | 14. Clock | 21. AUX |

• 1 •

Basic Operation

1. Power on/off and Mode (PWR/MOD)

Short press PWR/MOD to turn on; In working status, long press PWR/MOD to turn off.

2. Insert the U disk and SD/MMC/TF card and short press PWR/MOD, the selection sequence is as follows:

Radio → U disc → SD/MMC/TF → AUX → BT

↑

Insert the U disc or SD/MMC/TF card and press PWR/MOD, the mode will switch as follow:

Radio → U disc or SD/MMC/TF → AUX → BT

↑

Before inserting U disc or SD/MMC/TF card state, press PWR/MOD, the mode will switch as follow:

FM radio → AUX → BT

↑

3. Volume (Volume knob)

1) In default status, rotate (CW) the Volume knob to increase volume; rotate (CCW) the Volume knob to decrease volume. The adjustment range is 0 --- 32.

2) Short press the Volume knob, the selection sequence is as follows: BAS, TRE, BAL, FAD, LOUD, EQ, DX, STEREO.

Short press the Volume knob once time, the display will show "BAS 00", and then rotate (CW) the volume knob to increase bass or rotate (CCW) to decrease bass.

The adjustment rage is BAS-7-BAS07.

Short press twice, the display will show "TRE 00", and then rotate (CW) the volume knob to increase treble or rotate (CCW) to decrease treble. The adjustment rage is TRE-7-TRE07.

Short press trice, the display will show "BAL 00", and then rotate (CW) the volume knob to decrease the volume of the left speaker; rotate (CCW) the volume knob to decrease the volume of the right speaker. The adjustment range is L7-R7.

Short press four times, the display will show "FAD 00", and then rotate (CW) the volume knob to decrease the volume of the rear speaker; rotate (CCW) the volume knob to decrease the volume of the front speaker. The adjustment range is F7-R7.

Short press five times, the display will show "LOUD OFF". Then rotate the volume knob to choose "LOUD ON";

Short press six times, the display will show "EQ OFF, rotate the volume knob to choose "POP", "Class" and "ROCK";

Short press seven times, the display will show "DX", rotate the volume knob to select LOCAL;

Short press eight times, the display will show "STEREO", and then rotate the volume knob to select MONO.

4. EQ(EQ key)

In Mp3 status, press Volume knob to select POP, CLASS, and ROCK in sequence.

5. Mute (MUT key)

In power-on status, press MUT key to mute the sound, the display will flash MUT; press MUT key to resume the sound.

• 2 •

Radio

1. The unit can store 18 FM channels (FM1/FM2/FM3 every with 6 channels) and 12 AM channels (MW1/MW2 each with 6 channels). The frequency range of FM is 87.5MHz ~ 108MHz, with the step of 50KHZ, the frequency range of AM is 531kHz ~ 1602kHz, with the step of 9kHz.

2. Auto search stations (>>>/<<< key)

In radio status, press >>> or <<< key to automatically search the previous or next stations. If a station is found, the unit will stop searching and play the current station.

3. Manual search (>>>/<<< key)

In radio status, press and hold >>> or <<< key to switch to manual search mode, the device will manually search the previous >>> or <<< next station. When the favorite tation is app roaching, stop holding and press >>> or <<< key to fine adjust the frequency until you get your favorite station. The mode will switch to auto search without pressing within 5 seconds.

4. Auto storage (BND/AS key)

In radio status, press and hold BND/AS to automatically search stations backward and store the strong signal stations into 1-6 keys of FM1, FM2 and FM3 band. When storage completed, the device will play every station for 5 seconds, then press BND /AS to choose the station you want.

5. Manual storage (1-6 key)

In radio status, press and hold any one of 1-6 keys, the current station will be stored.

MP3 player

MP3 play is to play with U disc, SD/MMC/TF card.

In U disc play status, the display will show "USB"

In SD/MMC/TF card play status, the display will show "SD"

In U disc or SD/MMC/TF card play status, the display will also show the playing information as track number--Minute--Second.

1. Single (<<</>>>)

In MP3 play status, short press <<< or >>> to select the previous or next.

2. FR/FF (<<</>>>)

In MP3 play status, long press <<< or >>> to fastly reverse/forward.

3. Pause (1/PAU)

In MP3 play status, short press 1/PAU to pause, the display will show, short press 1/PAU again to play.

4. INT (2/INT)

In MP3 play status, short press 2/INT to play the first 10 seconds of each song, the screen will display INT. In this status, short press 2/INT again to cancel browse, the display will shortly show "ALL" and start normal play.

• 3 •

5. Repeat (3/RPT)

In the state of MP3, shortly press 3/RPT for the first time to repeat display single song, the screen will show word "RPT"; shortly press 3/RPT to cancel repeat.

6. Random (4/RDM)

In the state of MP3, shortly press 4/RDM to random display, the screen will show word "RDM"; shortly press 4/RDM again to cancel random display.

7. -10/+10 (5/-10 and 6/+10)

In MP3 play status, short press 5/-10 or 6/+10 to select the previous 10 songs or the next 10 songs. Long press to select the songs which in the folder.

CLOCK

1. Clock display

In MP3 play status, short press CLK, the display will show "CLOCK" instead of MP3 information. The unit will turn to MP3 information if no operation within 5 seconds. The clock is 24-hour clock.

2. Clock adjustment

Short press the CLK to show the time. Long press the CLK and then rotate the knob to change the hour. Pres again to change the minutes.

Bluetooth Function

1. Phone and unit matches

First, Please put the phone near the unit and find out the bluetooth function on the phone, and then search the Bluetooth's name ("CAR BT" password is "0000") then connected it to the unit.

2. Directly talk via Bluetooth

Marking calls.

After connect to the Bluetooth, make the calls on the phone directly. Answer the phone calls.

The unit has the bell ring when coming calls. Press the BND/AS button to answer the phone calls or answer it on the phone directly hang out the calls.

When you are making calls, press the "MOD" button to hang up the calls or hang it up on the phone directly.

3. Play the music by Bluetooth

After finish to connect to the bluetooth, press the "MOD" button to change to the state of "BT", and then start the music player on the phone to play the music.

• 4 •

Others

AUX IN

Press PWR/MOD key to switch to AUX IN status, press PWR/MOD key again to resume.

Remote Control Indication

(Note: Available for product supplied with remote)

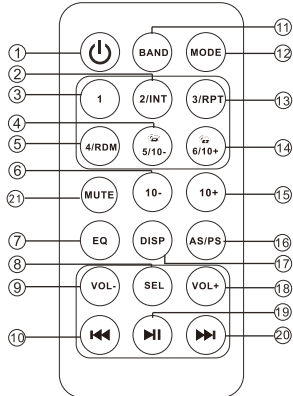

- | | |
|------------------------|--------------------------------------|
| ① Power | ② 2/INT |
| ③ 1 Number button | ④ 5/ -10 selection |
| ⑤ 4/ Random | ⑥ Previous 10 songs button |
| ⑦ EQ | ⑧ Audio control button |
| ⑨ Volume lessen | ⑩ Backward selection/Downward search |
| ⑪ Band Transfer | ⑫ Mode Transfer |
| ⑬ 3/ Repeat | ⑭ 6/ +10 selection |
| ⑮ Next 10 songs button | ⑯ Automatic storage |
| ⑰ Clock show | ⑱ Volume amplify |
| ⑲ Play/pause button | ⑳ Forward selection/Upward search |
| ㉑ Mute | |

• 5 •

Specification

FM

Frequency range ----- 87.5MHz~108MHz
 Maximum sensitivity ----- ≤ 37dBf
 Signal to noise ratio ----- ≥ 40dB
 Stereo separation ----- ≥ 20dB

AM

Frequency range ----- 531kHz ~ 1602kHz
 Maximum sensitivity ----- ≤ 40dB

MP3

Support format ----- MP3
 Music Storage ----- U disk /TF card
 Frequency response ----- (100Hz ~ 10 kHz) ± 8dB
 Signal to noise ratio ----- ≥ 50dB
 Channel separation ----- ≥ 35dB
 Harmonic voltage distortion ----- ≤ 5%
 Stereo channel balance ----- ≤ 3dB

General

Voltage ----- DC 12V (see label for specific)
 Output power ----- 50Wx4
 Speaker impedance ----- 4Ω ~ 8Ω
 Dimension of main frame ----- 178mm(W)x50mm(H)x98mm(D)

• 6 •

APP Control

Please scan the QR code to install the APP, or also you can enter into the website to install. For Android system: <https://play.google.com/store/apps/details?id=com.sz.easyway.ewaylink> For IOS system: <https://itunes.apple.com/cn/app/ewaylink/id1375833705?mt=8>

1. After installed, please find the icon and click it to enter, shown as picture 1.
2. Press this icon to enter in setting, then connect the phone with Bluetooth, shown as picture 2. After connected successfully, then you can control the device through your phone.



Androdi QR code



IOS QR code

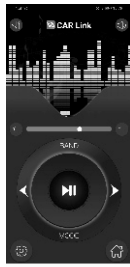

picture 1



picture 2

Connection diagram

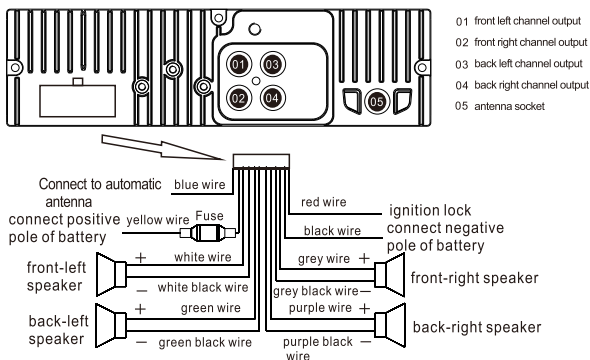

• 7 •

Installation

1. Please carefully read the manual before installation.
2. Please apply professional staff to install if possible.
3. Do not connect to power cable before other connection is done.
4. To avoid short circuit, please pack the exposed cable with insulating tape.
5. Fix all loose cable after installation completed.
6. This unit is designed to work with 12V (see label for specific) DC negative ground electrical system only. Please ensure your car meets the requirement.
7. Please connect the cables according to the color, wrong correction may lead to damage to the unit and the electrical system of the vehicle.

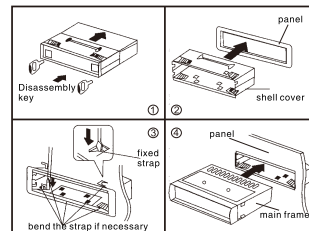

Installation steps

Troubleshooting

Problem	Cause	Solution
Power indicator is off	1. The power cord is connected in reverse.	Correctly connect the power cord. Check and connect both power cord.
No display	1. Yellow wiring is not connected to positive electrode of the battery.	Connect the yellow wiring to the positive electrode of the battery.
No sound	1. No power. 2. Speaker wiring is disconnected. 3. No sources in supported format In TF and U disk 4. The edge connector of TF and U disk is dirty lead to poor contact.	Connect the power cord. Connect the speaker wiring. Check the sources in TF and U disk. Clean with absolute alcohol.
Sound too low (noise)	1. Internal resistance of power supply is too loud 2. The antenna cable is loose.	Replace a new power supply. Push the antenna cable firmly into the plug.
Mono only	1. One of the speakers wiring is disconnected. 2. The power amplifier IC is damaged.	Connect the speaker wiring. Replace with a new power amplifier IC.

Note: Specifications are subject to change without prior notice.

• 8 •